

INTERSTATE 210 BUSINESS PARK

1665, 1595 & 1545 W. Casmalia Street, Rialto, California

THREE (3) BUILDINGS RANGING FROM ± 26,342 SF TO ± 49,009 SF



**LEE &
ASSOCIATES**

MICHAEL CHAVEZ
PRINCIPAL
LIC #00929693
909.373.2900
mchavez@lee-assoc.com

DAVID NGUYEN
SENIOR VICE PRESIDENT
LIC #01880998
909.373.2725
dnguyen@lee-assoc.com

RYAN EARNHART
SENIOR VICE PRESIDENT
LIC #01426559
909.373.2724
rearnhart@lee-assoc.com

VALENTINA CADOGAN
SENIOR ASSOCIATE
LIC #01829336
909.373.2903
vcadogan@lee-assoc.com

Voit
REAL ESTATE SERVICES

RYAN LAL, SIOR
SENIOR VICE PRESIDENT
LIC #01854104
909.545.8020
rlal@voitco.com

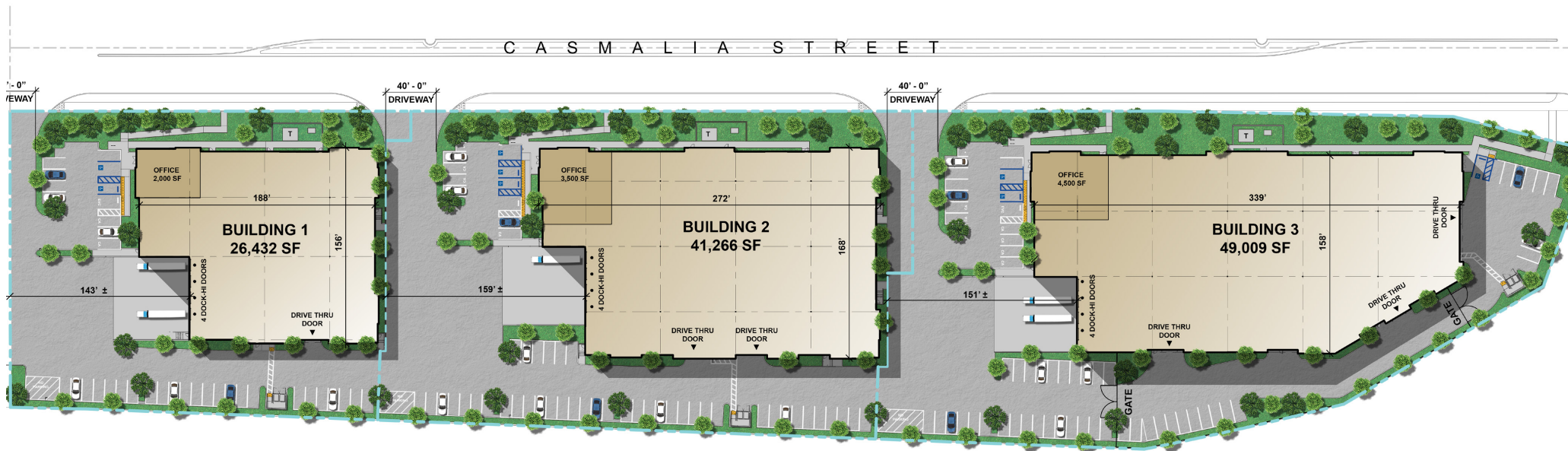

[CLICK HERE FOR BLDG. 1 VIRTUAL TOUR](#)

[CLICK HERE FOR BLDG. 2 VIRTUAL TOUR](#)

[CLICK HERE FOR BLDG. 3 VIRTUAL TOUR](#)

BUILDING 1: 1665 W. CASMALIA STREET

- ◆ 2,000 SF Office
- ◆ 32' Clear Height
- ◆ 4 Dock High Doors (9' x 10')
- ◆ 1 Ground Level Door (12' x 14')
- ◆ 143' Private Truck Court
- ◆ ESFR Sprinkler System (K-25 Heads)
- ◆ 800 amp, 277/480v, 3p 4w utility underground
- ◆ 3% Skylights
- ◆ 6" Warehouse Slab
- ◆ 60' x 52' Bay Spacing

BUILDING 2: 1595 W. CASMALIA STREET

- ◆ 3,500 SF Office
- ◆ 32' Clear Height
- ◆ 4 Dock High Doors (9' x 10')
- ◆ 2 Ground Level Doors (12' x 14')
- ◆ 159' Private Truck Court
- ◆ ESFR Sprinkler System (K-25 Heads)
- ◆ 1,200 amp, 277/480v, 3p 4w utility underground
- ◆ 3% Skylights
- ◆ 6" Warehouse Slab
- ◆ 60' x 52' Bay Spacing

BUILDING 3: 1545 W. CASMALIA STREET

- ◆ 4,500 SF Office
- ◆ 32' Clear Height
- ◆ 4 Dock High Doors (9' x 10')
- ◆ 3 Ground Level Doors (12' x 14')
- ◆ 151' Private Truck Court
- ◆ ESFR Sprinkler System (K-25 Heads)
- ◆ 2,000 amp, 277/480v, 3p 4w utility underground
- ◆ 3% Skylights
- ◆ 6" Warehouse Slab
- ◆ 60' x 52' Bay Spacing



BUILDING 1



BUILDING 2



BUILDING 3

